

➔ **Product Type**
PC Mount Miniature & Sub-Miniature Slide Switches

➔ **Product Series**
4S & 4M-Series

The 4S and 4M family of sub-miniature & miniature slide switches are composed of three switch series:

- 4S1-Series sub-miniature slide switch
- 4SS-Series sealed sub-miniature slide switch
- 4M1-Series miniature slide switch

These series of PC mount sub-miniature slide switches offer a variety of ratings, circuits, contact materials, and terminal platings. All series within the 4S and 4M family of switches are able to withstand temperatures from -30°C to $+85^{\circ}\text{C}$, and all offer PC mounting.

Certifications	4S1-Series & 4SS: No agency listings 4M1-Series: UL, CSA
Number of Poles	4S1-Series & 4SS-Series: 1 pole 4M1-Series: 1-2 pole
Ratings	3A @ 125VAC or 28VDC 1.5A @ 250VAC 5A @ 125VAC or 28VDC 2A @ 250VAC
Dielectric Strength	0.4VA max @ 20V max (AC/DC)
Insulation Resistance	1500 Volts RMS @ sea level
Actuator Style	1000 megohms (minimum)
Case Material	Slide
Slide Material	Dially phthalate (DAP) (UL 94V-0)
Housing Material	Nylon
Switch Support	Stainless Steel
Terminal Options	Brass, tin plated Solder Lug PCB PC Mount Quick Connect Wire Wrap
Mounting Hole Dimensions	See PDF elibrary file above for dimensions

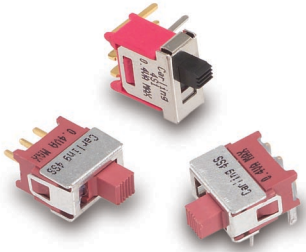

4S1 & 4SS-Series
Sub-Miniature &
Sealed Sub-Miniature
Slide Switches

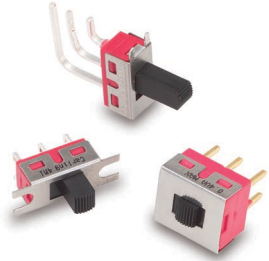

4M1-Series
Miniature Slide Switch

Specifications

Contact Rating refer to ordering scheme
 Electrical Life 30,000 make & break cycles at full load
 Contact Resistance. 10 mΩ max. initial @ 2-4 VDC
 100mA for both silver & gold plated contacts.
 Insulation Resistance 1000 MΩ min.
 Dielectric Strength 1500 Volts RMS @ sea level
 Operating Temperature . . . -30°C to +85°C
 Solder Heat Resistance. . . MIL-STD-202, Method 210
 Actuator Travel 25°

Materials

Case Diallyl phthalate (DAP) (UL 94V-0)
 Slide Handle. Nylon
 Housing. Stainless Steel
 Terminal Seal Epoxy

4S1-Series Ordering Scheme



1 SERIES 4S1 Sub-Miniature Slide Switch																
2 POLES FSP single pole																
3 CIRCUIT <table style="width: 100%; border-collapse: collapse;"> <tr> <td colspan="4" style="text-align: center;">Switching Position:</td> </tr> <tr> <td style="width: 10%;"></td> <td style="width: 15%;">2-1</td> <td style="width: 20%;">OPEN</td> <td style="width: 15%;">2-3</td> </tr> <tr> <td style="text-align: center;">1</td> <td>ON</td> <td>NONE</td> <td>ON</td> </tr> <tr> <td style="text-align: center;">3</td> <td>ON</td> <td>OFF</td> <td>ON</td> </tr> </table>	Switching Position:					2-1	OPEN	2-3	1	ON	NONE	ON	3	ON	OFF	ON
Switching Position:																
	2-1	OPEN	2-3													
1	ON	NONE	ON													
3	ON	OFF	ON													
4 TERMINATION M2 PCB M6 PC Mount, 90° horizontal																

5 CONTACT		
<i>Material</i>	<i>Terminal Plating</i>	<i>Rating</i>
G silver ¹	gold over silver ³	3A@125VAC or 28VDC; 1.5A @ 250VAC
K gold ²	tin-lead ⁴	0.4VA max. @20V max (AC/DC)
P silver ¹	tin-lead ⁴	3A@125VAC or 28VDC; 1.5A @ 250VAC
Q silver ¹	silver ¹	3A@125VAC or 28VDC; 1.5A @ 250VAC
R gold ²	gold ²	0.4VA max. @20V max (AC/DC)
NOTE: Tin-lead option available with PC type terminations only. 1 Moveable contact & terminals: copper alloy, silver plate 2 Moveable contact & terminals: copper alloy with gold plate over nickel plate 3 Terminals: silver plate with outer layer in gold plating		

6 EPOXY SEAL E epoxy seal
--

7 PACKAGING Switches are bulk packed, unless T/R is specified at the end of the part number. T/R tape reel - 500 pieces per reel
--

4S-Series Dimensional Specifications: in. [mm]

4S1-Series

TERMINATION

PC MOUNTING

M2

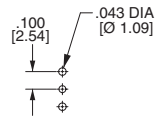
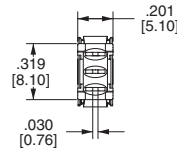
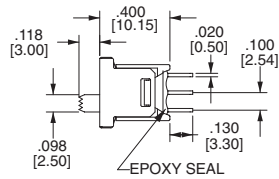
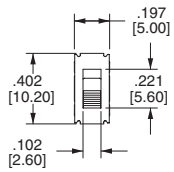

M6

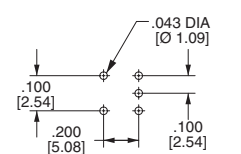
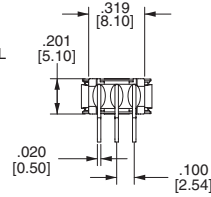
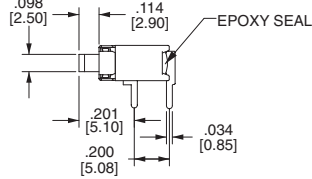
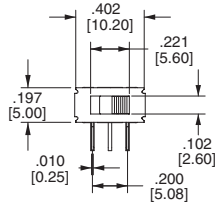

4SS-Series

TERMINATION

PC MOUNTING

M2

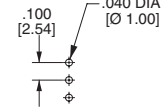
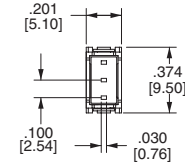
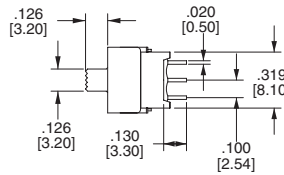
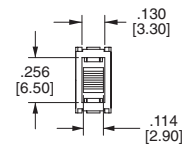

M6

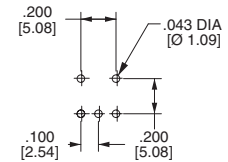
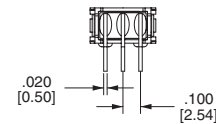
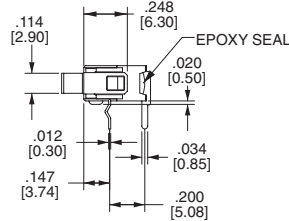
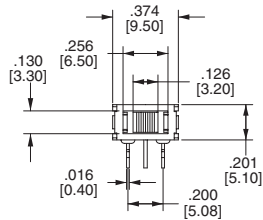

M7

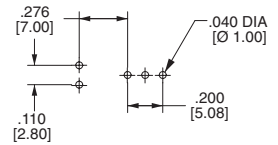
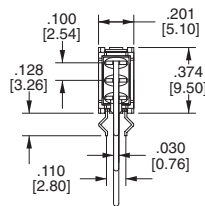
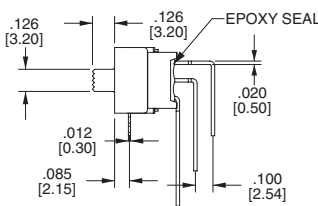
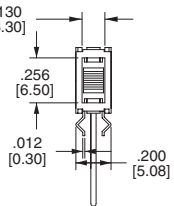

L6

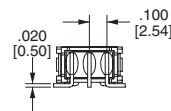
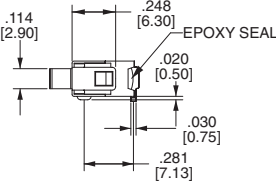
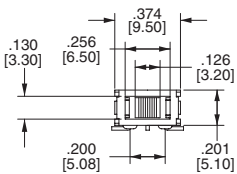

PC MOUNTING

